

# BUYING GUIDE • Heavy-Duty Stapler

Heavy-Duty staplers are perfect in shared areas or anywhere there is a need for stapling high sheet-count documents.

## FOR COPY ROOMS AND SHARED AREAS CONSIDER:

### Capacity

Heavy-duty staplers offer various sheet capacity capabilities, from two sheets through 215 sheets.

### Staple Type

Some heavy-duty staplers use different size staples for different sheet counts. Make sure you have the proper staples on hand for the model you select.

### Reduced Effort and Comfort

Look for reduced effort technology and soft touch accents for comfortable use and lower operating force.

### Jam Clearing

Select models offer jam free performance or a clearing mechanism to remove those pesky jams.

## FOR PERSONAL USE AT YOUR DESKTOP CONSIDER:

### Capacity

Choose smaller heavy-duty models that can accommodate up to 120 sheets.

### Stapling Capacity

For convenience, select a model that can accommodate the maximum amount of sheets without having to change staple size.

### Reduced Effort Technology

Many models are ergonomically designed with low force technology to help make stapling through large stacks of paper easy.

## FEATURES TO LOOK FOR

Anti-microbial finish

Flat clinch for neater stacking

Soft touch materials for comfort.

Adjustable throat depth for staple placement accuracy

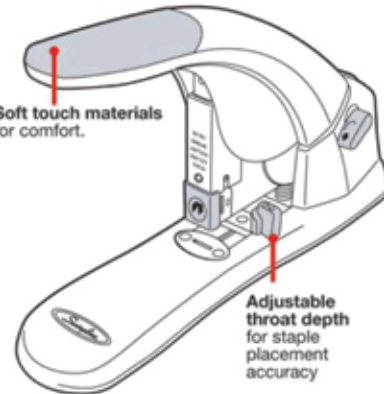

## Less effort with a light touch

One size staple needed to staple 20-120 sheets



**A LightTouch® Heavy-Duty Stapler** Staples from 20 to 120 sheets with one staple size and 50% less effort. Jam-clearing knob and adjustment guide. Metal with soft touch accents. Throat depth adjusts to 2¾". One-button front-loading cartridge for a full strip (100) of ½" heavy duty staples. Package includes 500 staples. Manufacturer's limited lifetime warranty. All sheet capacities are based on 20-lb. bond.

ID No.	Sheet Capacity	Color	Unit	Price
1 SWI-90010	120	Black/Gray	EA	115.28

### LightTouch® Heavy-Duty Staples

ID No.	Strip Count	Staples Per Unit	Unit	Price
2 SWI-90009	100	2,500	BX	10.93



**B Heavy-Duty Stapler** Staple-gun mechanism in a desktop design is 70% easier to use than traditional heavy-duty staplers! Saves desktop space—revolutionary design is two-thirds smaller than traditional heavy-duty staplers. Metal and plastic construction with non-slip rubber grip on handle and base. Hard chromed strike plate, staple track and anvil. Bottom loads a full strip (100) ½" heavy-duty staples. Package includes two boxes of heavy-duty staples. Manufacturer's two-year warranty. All sheet capacities are based on 20-lb. bond.



ID No.	Sheet Capacity	Color	Unit	Price
3 ACI-1200	60	Black/Gray	EA	43.79
4 ACI-1210	65	Black/Silver	EA	56.29
5 ACI-1300	100	Black/Silver	EA	89.99



## BOSTITCH

**C Auto 180™ AntiJam™ Heavy-Duty Stapler** Stapler measures stack from two to 180 sheets and cuts the staple for a perfect clinch. One size staple needed to staple 2-180 sheets! AntiJam™ mechanism. Bi-material handle design, locking paper stop and push-button magazine release. Front loads heavy-duty staples. Package includes 800 custom staples. Manufacturer's limited seven-year warranty. All sheet capacities are based on 20-lb. bond.

ID No.	Sheet Capacity	Color	Unit	Price
6 BOS-B380HD-BLK	180	Black/Beige	EA	154.59

### Heavy-Duty Staples

ID No.	Strip Count	Staples Per Unit	Unit	Price
7 BOS-SB38HD-1M	100	1,000	BX	9.59

## BOSTITCH

### D AntiJam™ Extra Heavy-Duty Stapler

Get the leverage you need for large stapling jobs with the long arm of this heavy-duty desktop stapler. AntiJam™ stapling channel. Drives ¾", ½", ⅜", ¼" and ⅛" heavy-duty staples. All metal with an antimicrobial finish. Adjustable paper stop with standard and metric rulers. Throat depth adjustable up to 2¾". Rear loading. Manufacturer's seven-year warranty. All sheet capacities are based on 20-lb. bond.



ID No.	Sheet Capacity	Color	Unit	Price
8 BOS-00540	215	Black	EA	145.59